

Installation manual  
**Latte LED IP54**

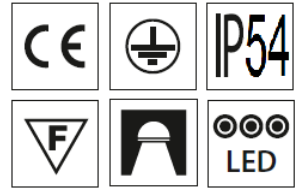

220-240V/50-60Hz

**1. Dimensions:**

Power [W]	W [mm]	L [mm]	H [mm]	Weight [kg]
24	110	1160	90	2,0
46	160	1160	90	2,6
19	330	330	85	1,7

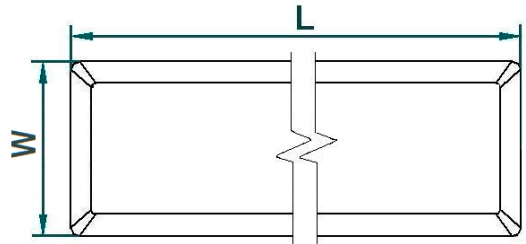

**2. Installation:**

- carefully take the fixture out of box and put it on a stable surface;
- rotate the diffuser securing holders by 90°, take the diffuser out of the luminaire;
- put power cable through the hole in base of frame;
- screw the luminaire to the ceiling; Fixture is mounted on the ceiling by two pins in the "A" spacing, see: table below;
- connect the wires as shown on a cube;
- put the diffuser back on the luminaire and secure it by rotating the holders.



Power	F	E	A	B
24	1150	100	650	50
46	1150	150	650	50
19	320	320	99	-

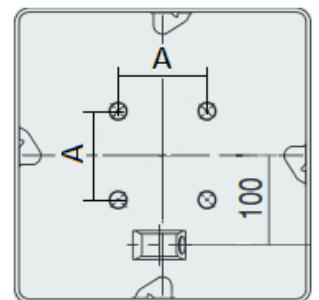
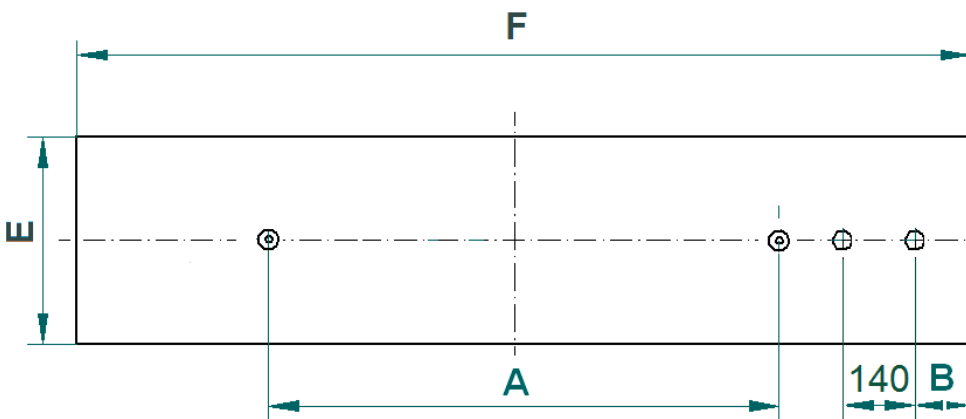
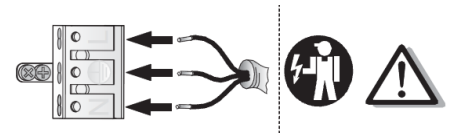

**3. Important warnings:**

- The luminaires may be installed by qualified registered personnel only.
- Any manipulation inside the luminaires when the power is activated causes the risk of electrical shock.
- The manufacturer is not responsible for any flaws resulting from non-compliance with these instructions.
- The manufacturer reserves the right to change the construction of the luminaire.
- Do not install the luminaire in places without sufficient air circulation.
- To guarantee safe luminaire functioning, please follow the installation instructions.



The European Directive 2002/96/EC on waste electrical and electronic equipment, requires that electric and electronic devices must not be disposed of in the normal household waste. The crossed out wheeled bin is reproduced in order to remind obligations towards separate collection. For correct disposal, please use authorized waste disposal facilities or return to the distributor at the date a new lighting fitting is purchased. Lamps, if disposed together with the lighting fitting, shall not be broken up since they contain substances which are highly polluting to the environment. Unauthorized disposal of the foregoing waste material is punishable by law. For the Directive details please visit: <http://eur-lex.europa.eu/legal-content/en/ALL/?uri=CELEX:32002L0096>

