

Installation manual

Sigma LED / Sigma DI-IN LED
Sigma II LED / Sigma II DI-IN LED



Smooth adjustment of fasteners spacing (only for DI version)

220-240V/50-60Hz

1. Dimensions:

Power [W]/ Power [W] DI-IN	PAR/OPAL/MPRM	L [mm]	Weight [kg]/ Weight [kg] DI-IN	Dim. A
14 / -	PAR	545	1,4 / -	-
14; 27 / 21; 37	PAR	1085	2,5 / 2,85	724
21; 40 / 31; 59	PAR	1625	3,4 / 3,9	1084
27; 51 / 41; 73	PAR	2170	4,8 / 5,65	1448
8; 13 / -	OPAL/MPRM	545	1,3 / -	-
14; 25 / 21; 39	OPAL/MPRM	1085	2,3 / 2,65	724
21; 36 / 31; 58	OPAL/MPRM	1625	3,2 / 3,7	1084
28; 48 / 40; 77	OPAL/MPRM	2170	4,5 / 5,35	1448

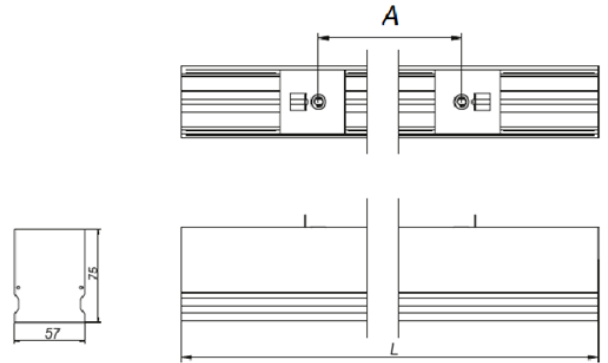

2. Installation:

- a) Turn off the power at the electrical circuit the luminaire is going to be connected to
- b) Assemble the suspension kits (accordingly to the separate instruction manual) – suspended version.
- c) Take the luminaire out of the package.
- d) Ceiling installation:



Fig.1

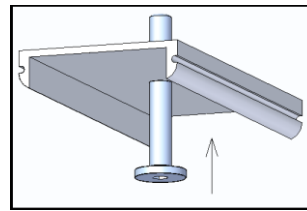
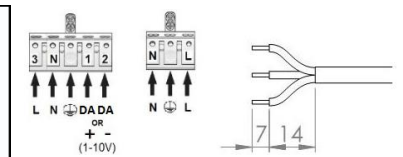

Fig.2



Install surface-mounting brackets on the ceiling (NT version) as in Fig.1., then plug the power cable accordingly to markings as in Fig.2. and click luminaire in the brackets.

Suspended installation, DI version :

Install wire regulators as in Fig.4. (suspended version) then pull the power cable through the regulator and connect it accordingly to the markings as in Fig.2.

Suspended installation, DI-IN version :

Remove the top opal diffuser of the luminaire. Install suspension wire regulators as in Fig.4., then pull the power cable through the hole in an opal diffuser. Push the diffuser up to the ceiling (temporarily, for the time of the installation). Then thread the suspension wires through the regulators and connect the power cable accordingly to the terminal markings as in Fig.2. Pull the luminaire down and slide in the top diffuser.

Fig.4

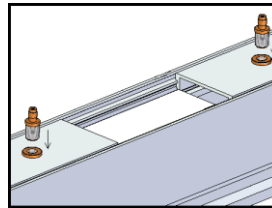

Fig.5

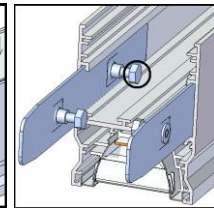
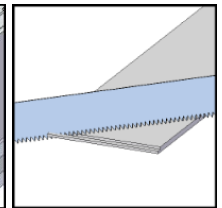

Fig.6.



If the luminaire is installed in a line – before putting the top diffuser back follow the manual for the light-line installation.

- e) For single-mounted luminaires the diffuser needs to be shortened to the length of the profile as in Fig.6. (OPAL+MPRM version) so it does not push the end caps out. It does not apply to luminaires with plastic end-caps.

Light-line installation

Light-line installation should be done using the linear joints that are to be slid into the profile and tightened using the attached screws (Fig. 5) The screws should be tightened without using too much force not to cause any deformation to the profile.

Afterwards slide the second luminaire onto the joint and tighten the second set of screws. Connect the fast-plugs of through wiring and connect the power supply to one of the luminaires in the line accordingly to the markings as in Fig.2.

3. Important warnings:

The manufacturer cannot be considered liable for any damages deriving from improper, wrong and unreasonable use of the fitting. Luminaries may be installed by qualified personnel only. Any manipulation inside the luminaire when power supply is on causes the risk of electric shock. Manufacturer is not responsible for any flaws caused by avoid using this manual. Manufacturer reserves a right to change the construction of the product. Do not assembly in places without air circulation. To guarantee safety of luminaire functions, please assembly according to instruction.

