

**Installation manual**  
**VIP MINI LED CORNER**

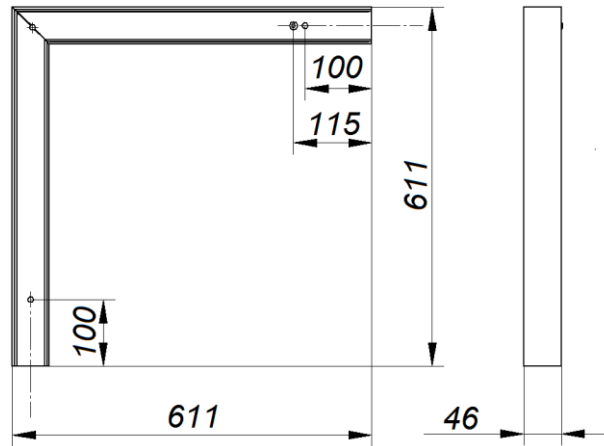

**220-240V/50-60Hz**  
**LED**

Power [W]	Weight [kg]
31	1,9 kg



- Turn off the power in the circuit which the luminaire is going to be connected to.
  - Install the luminaire's suspension (follow the suspension's instruction manual)
  - Carefully take the luminaire out of the package.
  - Slide out the diffuser and detach the LED module fixed with screws.
  - Install the regulators included in set with the luminaire.
  - Pull the suspension wires through the regulators (wires are included in the set).
  - Pull the feeding cable through the hole in the luminaire and connect it as indicated on the connection terminal.
  - Connect the LED source cables to the connection terminals in the luminaires as indicated in the picture. Pay special attention to the polarity while connecting the cables. (ATTENTION: Reverse connection of the cables may result in damaging the LED sources.)
  - Reattach the plate with the LED module.
  - Slide the diffuser back in and fix the end caps to the luminaire.
- ATTENTION:**
- to connect the luminaires in line, linear joints should be used,
  - at the end of a luminous line, attach the end caps.

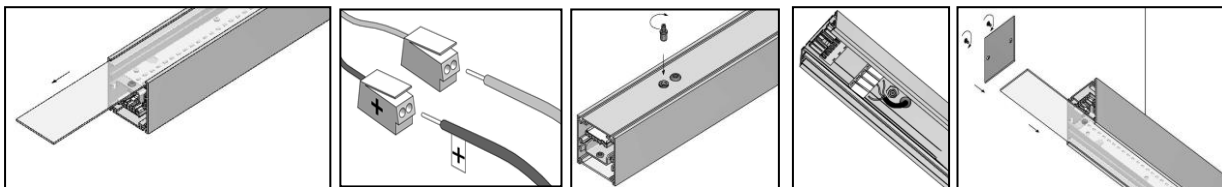
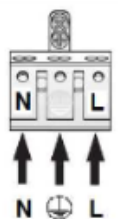

**Important warnings:**

The luminaires may be installed by qualified registered personnel only. Any manipulation inside the luminaires when the power is activated rises a risk of an electrical shock. The manufacturer is not responsible for any flaws resulting from non-compliance with these instructions. The manufacturer reserves the right to change the construction of the luminaire. Do not install the luminaire in places without sufficient air circulation. To guarantee safe luminaire operation, please follow the installation instructions.



The European Directive 2002/96/EC on waste electrical and electronic equipment, requires that electric and electronic devices must not be disposed of in the normal household waste. The crossed out wheeled bin is reproduced in order to remind obligations towards separate collection. For correct disposal, please use authorized waste disposal facilities or return to the distributor at the date a new lighting fitting is purchased. Lamps, if disposed together with the lighting fitting, shall not be broken up since they contain substances which are highly polluting to the environment. Unauthorized disposal of the foregoing waste material is punishable by law.

